

# APP User Manual

## 目录

1 About This Manual .....	5
1.1 Purpose .....	5
1.2 Audience .....	5
1.3 Scope of Application .....	5
1.4 Symbols .....	5
1.5 Revision History .....	5
2 Product Information .....	6
2.1 M-Cloud Introduction .....	6
2.2 System Composition .....	6
3 Registration .....	7
3.1 Download APP .....	7
3.2 Registration Methods .....	7
3.2.1 Email Registration .....	7
3.2.2 Phone Number Registration .....	11
4 Login .....	15
4.1 Login .....	15
4.2 Forgot Password .....	16
4.3 Stay Log In .....	17
5 Logout .....	17
5.1 Logout Interface .....	17
5.2 Interface After Logout .....	18
6 Personal Information .....	19
6.1 Change Avatar .....	19
6.2 Change Nickname .....	20
6.3 Bind Email & Phone Number .....	21
6.4 Change Login Password .....	22
6.5 Account Deletion .....	23
7 Create a plant .....	24
7.1 Enter .....	24
7.2 Bind Information .....	24
7.3 Complete Creation .....	26
8 Network Configuration .....	26
8.1 WiFi Configuration .....	26
8.2 MESH Configuration .....	28
9 Plant Monitoring .....	32
9.1 Overview .....	32

9.1.1 Total Power of Plant Station .....	32
9.1.2 Power Generation Data .....	32
9.1.3 Investment Return & Energy-Saving Emission Reduction .....	33
9.1.4 More .....	35
9.2 Equipment .....	37
9.2.1 Equipment Overview .....	37
9.2.2 Gateway .....	39
9.2.3 Micro Inverter .....	40
9.3 Events .....	42
9.4 Layout .....	43
9.5 Topology .....	45
10 Equipment .....	45
10.1 Inverter Overview .....	45
10.1.1 Inverter Type .....	45
10.2 Gateway Overview .....	46
10.2.1 Gateway Type .....	47
10.2.2 Gateway Details .....	47
11 Events .....	47
11.1 Inveter .....	47

## Legal Notice

MOCOWINI has made every effort to ensure the accuracy and completeness of this manual.

However, due to product upgrades or user feedback, this manual may be changed and revised.

MOCOWINI reserves the right to modify this manual at any time without prior notice. The latest version of the manual can be obtained by visiting the MOCOWINI official website ([www.mocowini.com](http://www.mocowini.com)) or scanning the QR code below.

If you have any technical questions or inquiries about our products, please contact our support team through the MOCOWINI service portal.

# 1 About This Manual

## 1.1 Purpose

This manual provides an overview and operating procedures for using the M-Cloud platform, aiming to help you use the platform effectively.

Hereinafter, unless otherwise stated, the platform will be referred to as M-Cloud or Web for short.

## 1.2 Audience

This manual is intended for distributors and installers.

## 1.3 Scope of Application

This manual applies to micro inverters and gateways.

## 1.4 Symbols

NOTE : This symbol indicates additional information for emphasis or supplement to the main text.

## 1.5 Revision History

The following are the main changes between this version and the previous one.

Version	Date	Description
V2.0	2025.05	Update

## 2 Product Information

### 2.1 M-Cloud Introduction

M-Cloud is an intelligent platform for monitoring and managing your photovoltaic system. It offers functions such as equipment operation tracking, visual layout, remote parameter setting, alarm information, power generation and revenue analysis. The platform also ensures remote operation and maintenance (O&M), optimizing overall efficiency.

M-Cloud can be viewed on mobile applications and web pages, with the interface varying according to your role. The Installer interface is for installers and distributors, offering customized functions. The Owner interface is for end-users, focusing on ease of use and simplicity.

This manual mainly introduces using the APP on mobile devices. For detailed web operation information, please refer to the "M-Cloud (Web) User Manual" (Global Edition) V202410.

### 2.2 System Composition

A typical MOCOWINI micro inverter system consists of three main components: micro inverters, gateways, and M-Cloud.

The gateway can be fixed in the micro inverter.

The inverter converts DC power to AC power and transmits performance data to the gateway. The gateway then sends this data to M-Cloud. Finally, M-Cloud allows you to monitor system performance online and provides diagnostic tools for effective system management.

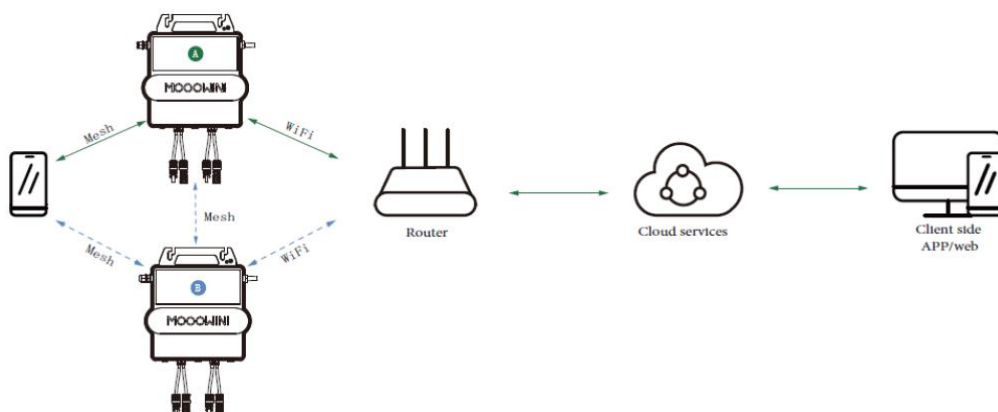

## 3 Registration

### 3.1 Download APP

·Download the latest version of the APP from the IOS or Android platform.

### 3.2 Registration Methods

·Email registration

·Phone number registration

#### 3.2.1 Email Registration

Step 1:

The APP icon after download:



Step 2:

Click on the icon to open the APP:

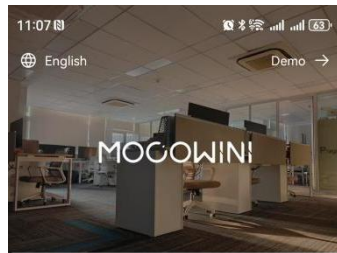

Log in

Please input your E-mail

Please enter password

☐ Stay Logged In
 [Forgot Password](#)

Log in

☐ I have read and agreed to the [User Agreement](#)  
 No account? [Register](#)

Step 3:

Click on "Register" at the bottom as shown in the figure

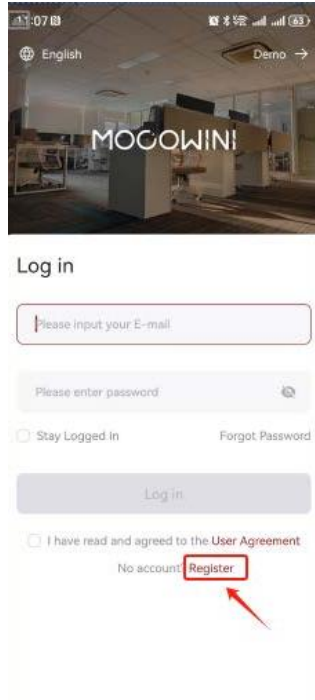

Step 4:

Enter the interface as shown in the figure:

11:13

←

Sign Up

E-mail

Phone Number

Please input E-mail

Please input verification

Get Code

●

The password length is 8-20 digits; Contain numbers and letters, and at least one capital letter; No spaces, Chinese or special symbols.

Please enter password

Confirm Password

Sign Up

☐ I have read and agreed to the [User Agreement](#)

### Step 5:

Correctly enter the email account, click "Get Code", and after receiving the verification code, fill it in the input box on the left as shown in the figure:

11:15

←

Sign Up

E-mail

Phone Number

88888888@gmail.com

Please input verification

Get Code

●

The password length is 8-20 digits; Contain numbers and letters, and at least one capital letter; No spaces, Chinese or special symbols.

Please enter password

Confirm Password

Sign Up

☐ I have read and agreed to the [User Agreement](#)

→

11:15

←

Sign Up

E-mail

Phone Number

88888888@gmail.com

1234

Get Code

●

The password length is 8-20 digits; Contain numbers and letters, and at least one capital letter; No spaces, Chinese or special symbols.

Please enter password

Confirm Password

Sign Up

☐ I have read and agreed to the [User Agreement](#)

Note: On the current interface, even if the verification code countdown ends, the verification code is still valid.

Region: Global    2025    V2.0

9

www.mocowini.com

### Step 6:

Design a password as required, which needs to contain numbers and letters with at least one capital letter, then re-enter the designed password to activate it. You can compare whether the two passwords are the same by clicking the eye icon to view intuitively as shown in the figure:

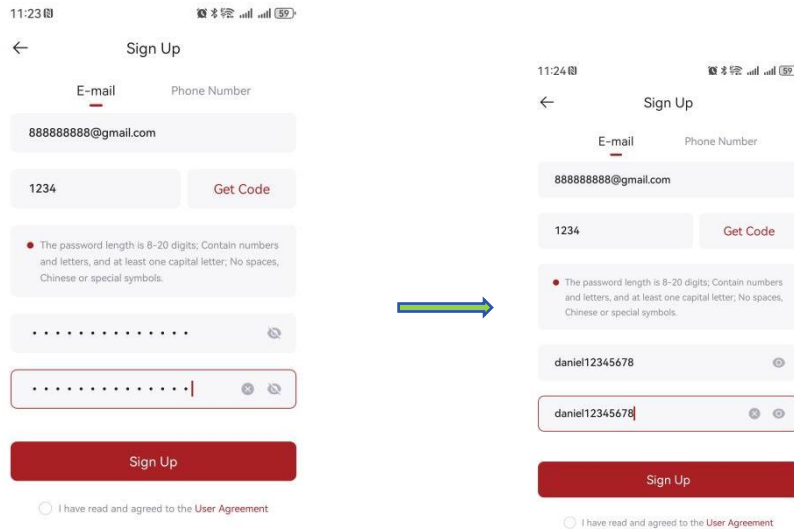

### Step 7:

Check the box for "I have read and agreed to the user agreement", then click "Sign Up" to complete the registration process.

11:26

←

Sign Up

E-mail

Phone Number

88888888@gmail.com

1234

Get Code

• The password length is 8-20 digits; Contain numbers and letters, and at least one capital letter; No spaces, Chinese or special symbols.

daniel12345678

daniel12345678

Sign Up

✓

I have read and agreed to the [User Agreement](#).

### 3.2.2 Phone Number Registration

Step 1:

The APP icon after download:



Step 2:

Click on the icon to open the APP:

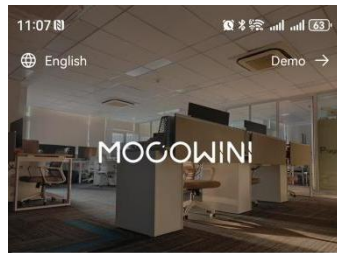

Log in

Please input your E-mail

Please enter password

☐ Stay Logged In
 [Forgot Password](#)

Log in

☐ I have read and agreed to the [User Agreement](#)  
 No account? [Register](#)

Step 3:

Click on "Register" at the bottom as shown in the figure:

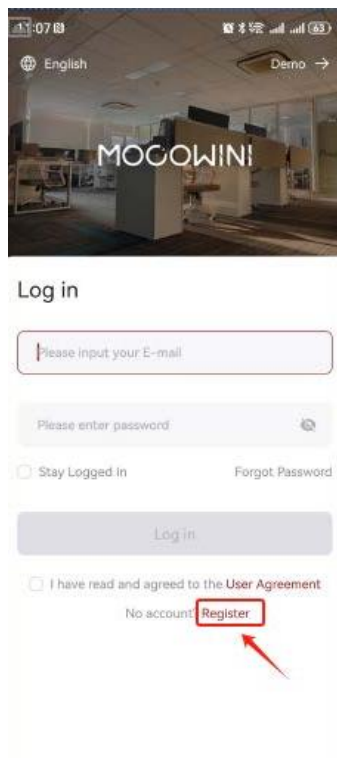

Step 4:

Enter the "Phone Number Registration" interface, input "Phone Number" as shown in the figure:

11:31

←

Sign Up

E-mail

Phone Number

Please input phone number

Please input verification

Get Code

● The password length is 8-20 digits; Contain numbers and letters, and at least one capital letter; No spaces, Chinese or special symbols.

Please enter password

Confirm Password

Sign Up

☐ I have read and agreed to the User Agreement

11:32

←

Sign Up

E-mail

Phone Number

12345678910

Please input verification

Get Code

● The password length is 8-20 digits; Contain numbers and letters, and at least one capital letter; No spaces, Chinese or special symbols.

Please enter password

Confirm Password

Sign Up

☐ I have read and agreed to the User Agreement

### Step 5:

After correctly entering the phone number, click "Get Code", then fill in the verification code as shown in the figure:

11:32

←

Sign Up

E-mail

Phone Number

12345678910

Please input verification

Get Code

● The password length is 8-20 digits; Contain numbers and letters, and at least one capital letter; No spaces, Chinese or special symbols.

Please enter password

Confirm Password

Sign Up

☐ I have read and agreed to the User Agreement

11:32

←

Sign Up

E-mail

Phone Number

12345678910

1234

Get Code

● The password length is 8-20 digits; Contain numbers and letters, and at least one capital letter; No spaces, Chinese or special symbols.

Please enter password

Confirm Password

Sign Up

☐ I have read and agreed to the User Agreement

### Step 6:

Region:

Global

2025

V2.0

13

www.mocowini.com

Design a password as required, which needs to contain numbers and letters with at least one capital letter, then re-enter the designed password to activate it. You can compare whether the two passwords are the same by clicking the eye icon to view intuitively as shown in the figure:

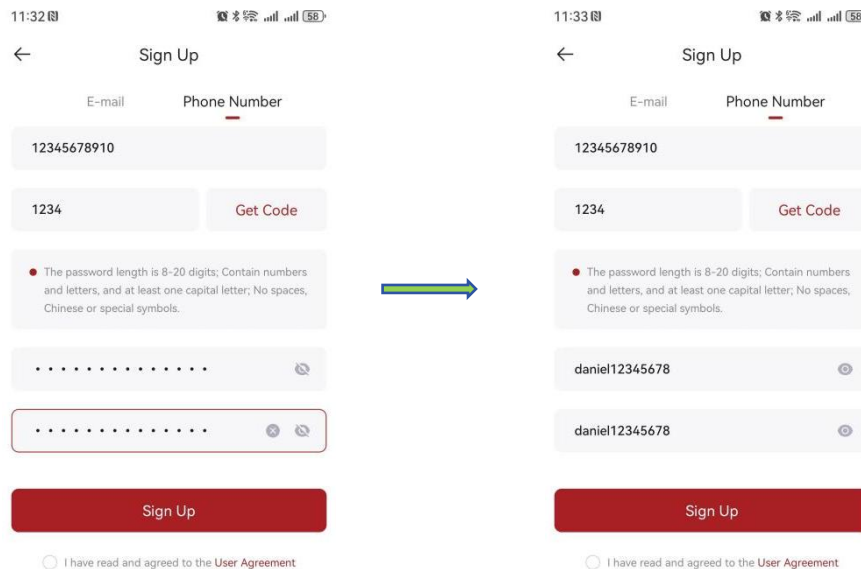

### Step 7:

Check the box for "I have read and agree to the user agreement", then click "Sign Up" to complete the registration process.

11:33

Signal strength icons

← Sign Up

E-mail

Phone Number

12345678910

Get Code

1234

• The password length is 8-20 digits; Contain numbers and letters, and at least one capital letter; No spaces, Chinese or special symbols.

daniel12345678

🔄

daniel12345678

🔄

Sign Up

☒ I have read and agreed to the User Agreement

## 4 Login

## 4.1 Login

Correctly enter the phone number and password, check "I have read and agree to the user agreement", then click "Login" as shown in the figure:

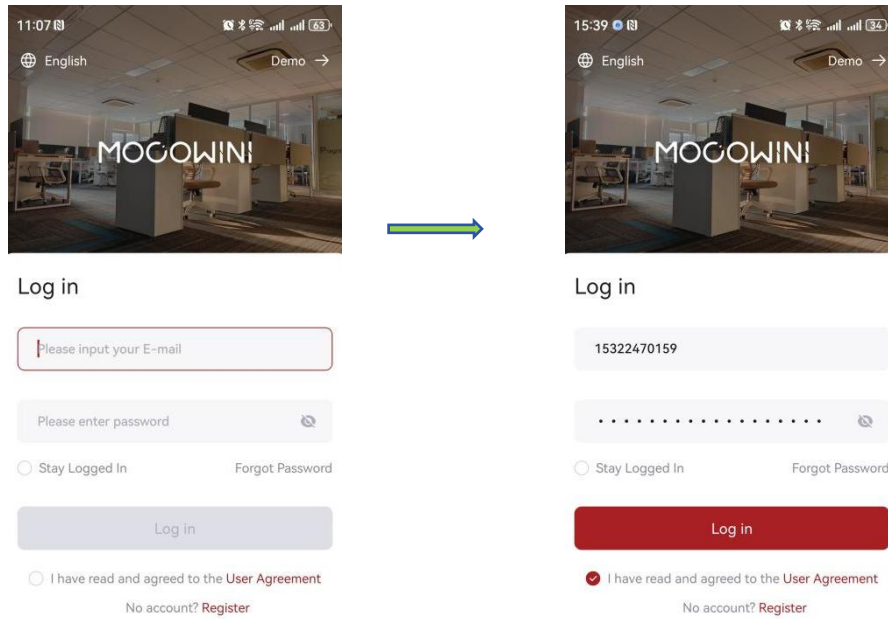

## 4.2 Forgot Password

If you forget your password, you can click "Forgot Password" below the password box on the login interface as shown in the figure:

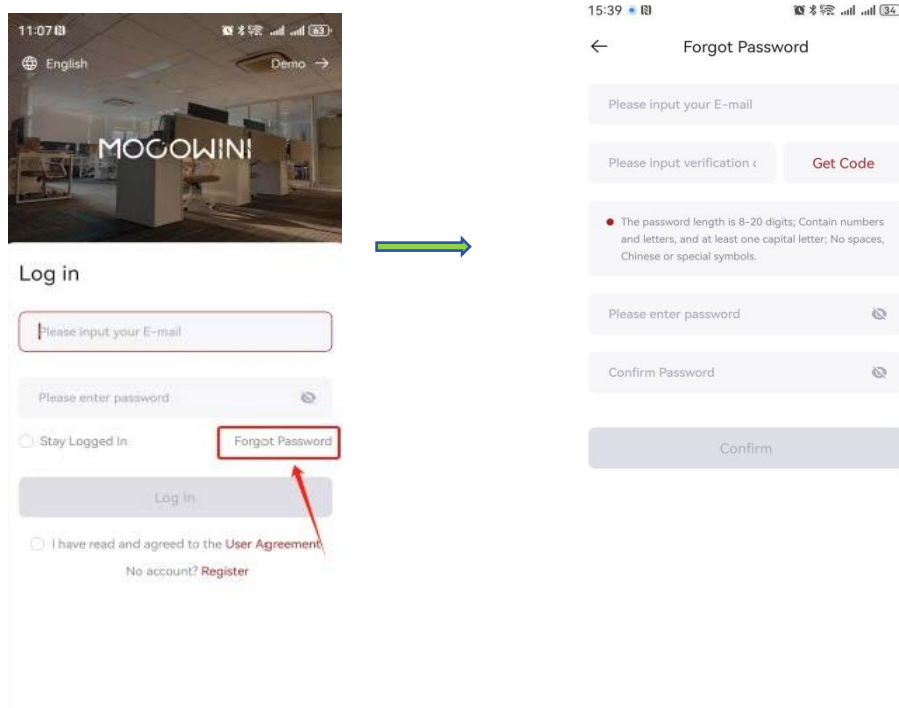

Tip: You can use a new phone number or the registered phone number to redesign the password and then log in again.

## 4.3 Stay Log In

After entering your account and password, click "Log In", check the box, then click "Login".

When you close the app in the background and reopen it, you can directly enter the app as shown in the figure:



Log in

daniel@mocowini.com

.....

☒ Stay Logged In
 [Forgot Password](#)

Log in

☒ I have read and agreed to the [User Agreement](#)

No account? [Register](#)

Note: After checking "Log In", the phone system may pop up a "Save Password" prompt, click"OK". After exiting the APP, the login interface will show the account but not the password.

## 5 Logout

### 5.1 Logout Interface

Click on "Me" on the right side of the operation bar, click on the avatar above the screen to see "Sign out" as shown in the figure:

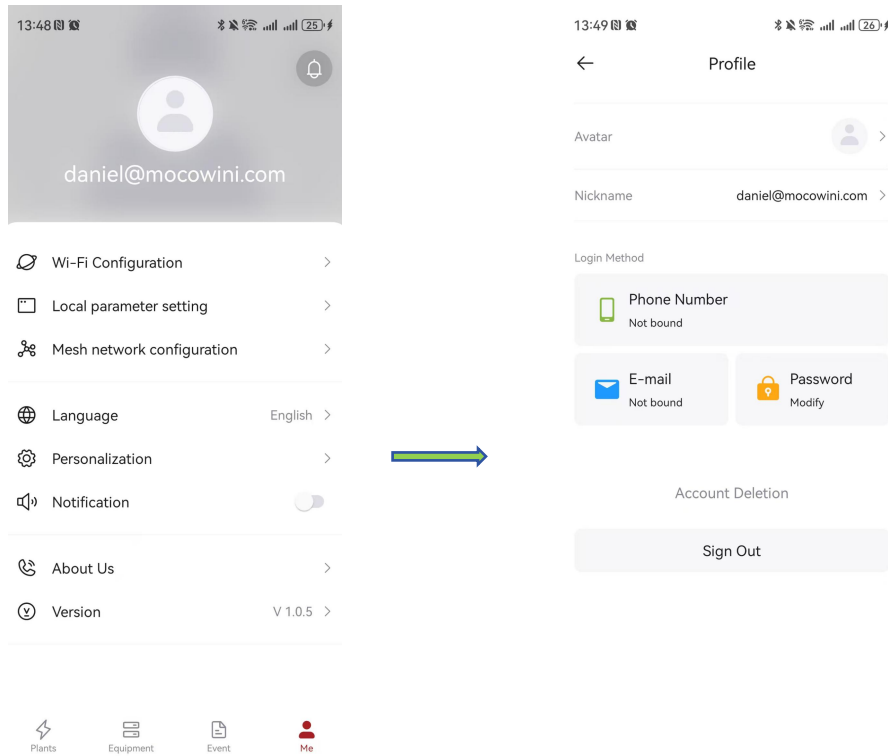

## 5.2 Interface After Logout

After logging out via method 5.1, the login interface will only retain the account, and all other information will be reset.



## 6 Personal Information

Click on "Me" at the bottom right of the main interface, then click on the "Avatar" to enter the personal information interface as shown in the figure:

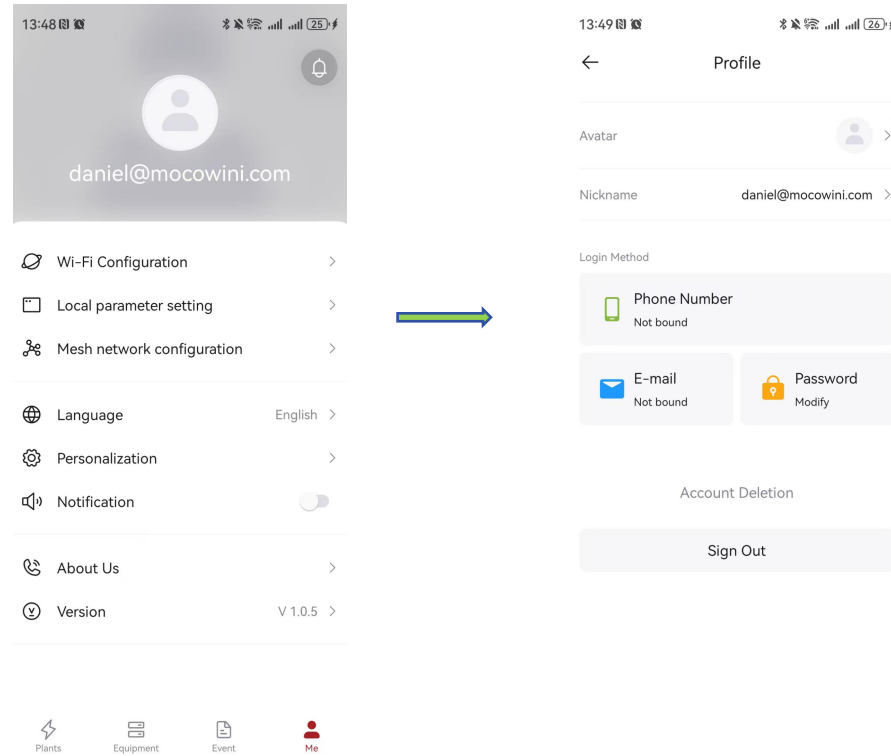

### 6.1 Change Avatar

Click on "Avatar", you can choose to "Take Photos " or "Choose from Library", select a picture as your avatar as shown in the figure:

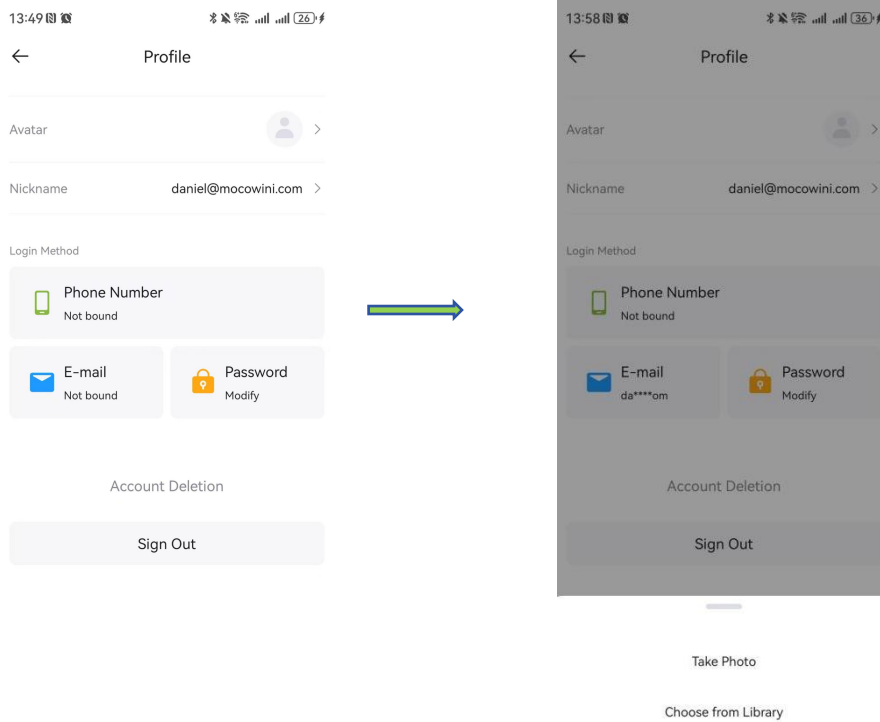

## 6.2 Change Nickname

Click on "Nickname", enter the interface, design your nickname, then click "Save" to activate it as shown in the figure:

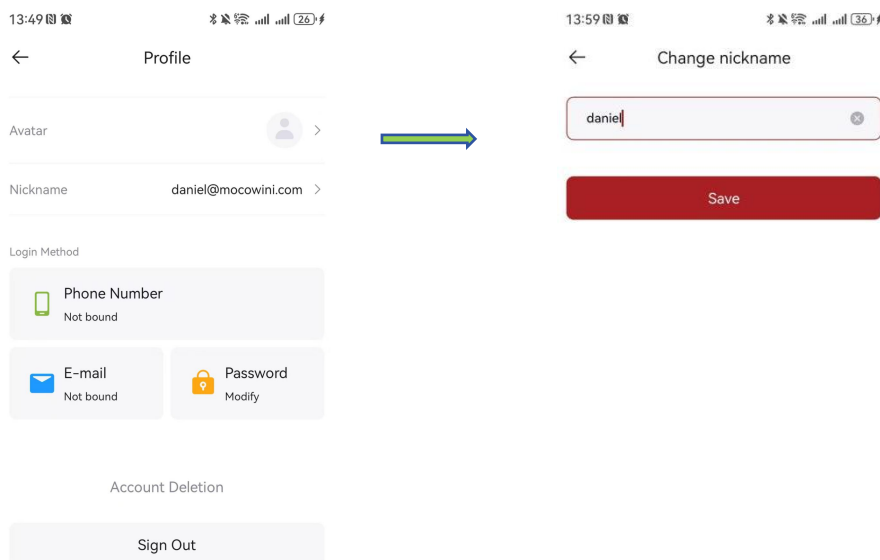

## 6.3 Bind Email & Phone Number

For Email registration:

Click on "Email", enter the email to be bound, click "Get Code", fill in the verification code box, then click "Bind" to complete the email binding.

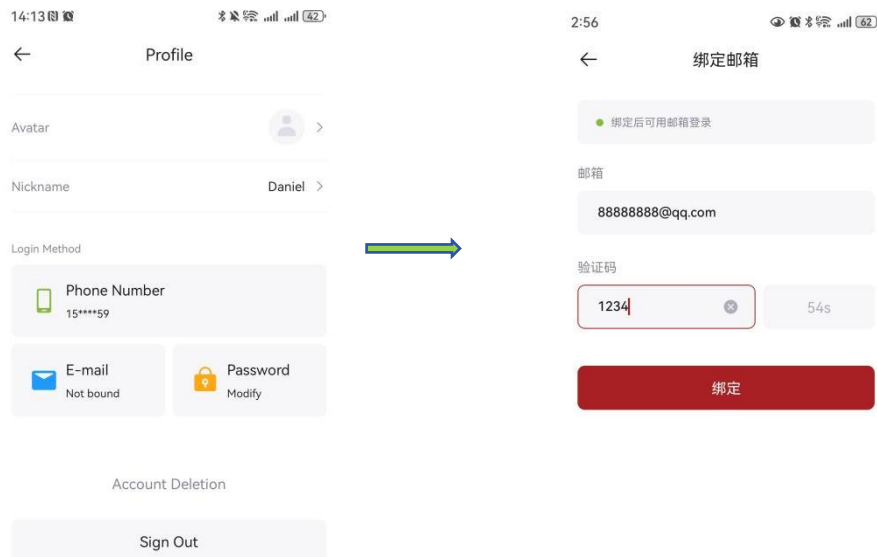

For Phone Number registration:

Click on "Phone Number", enter the phone number, click "Get Code", fill in the verification code box, then click "Bind" to complete the phone number binding.

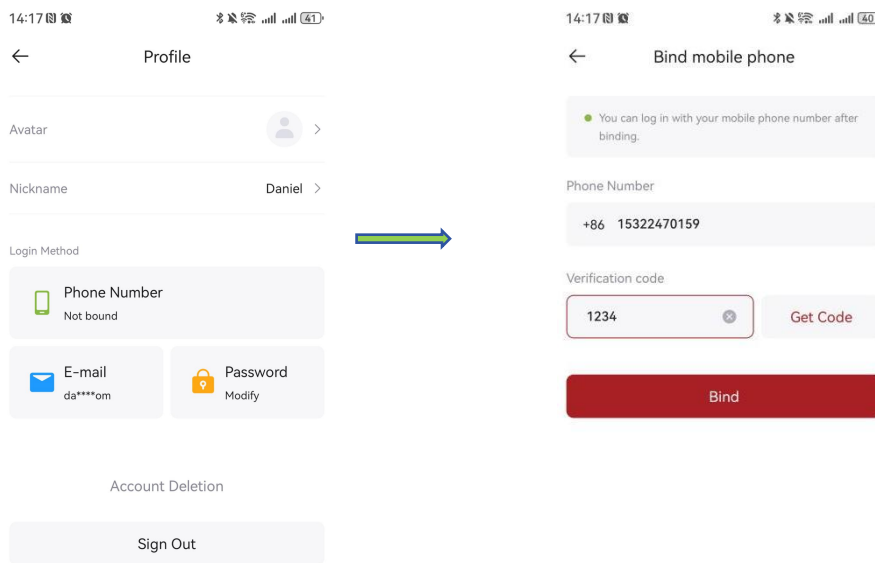

## 6.4 Change Login Password

Click on "Modify", enter the current login password in "Old Password", design a new password according to the requirements on the page in "New Password", then re-enter the new password in "Confirm", and confirm to activate it as shown in the figure:

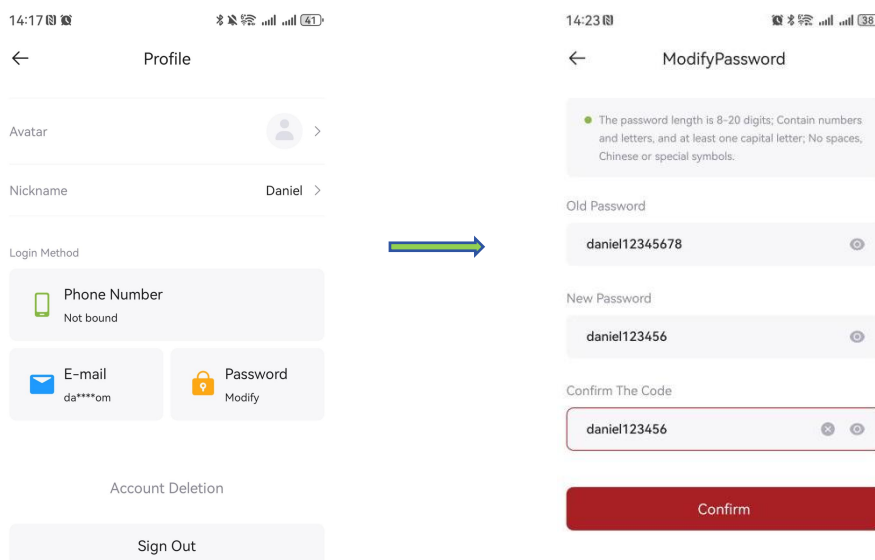

Note: If you are unsure about the password, you can click the eye icon to view and confirm

## 6.5 Account Deletion

Click on "Account Deletion", enter the page, check "I have read and agree to the above important reminders", click "Account Deletion", enter the next page, the content in the "Current Account" box cannot be modified, click "Get Code", enter the verification code, then click "Delete" to complete the process as shown in the figure:

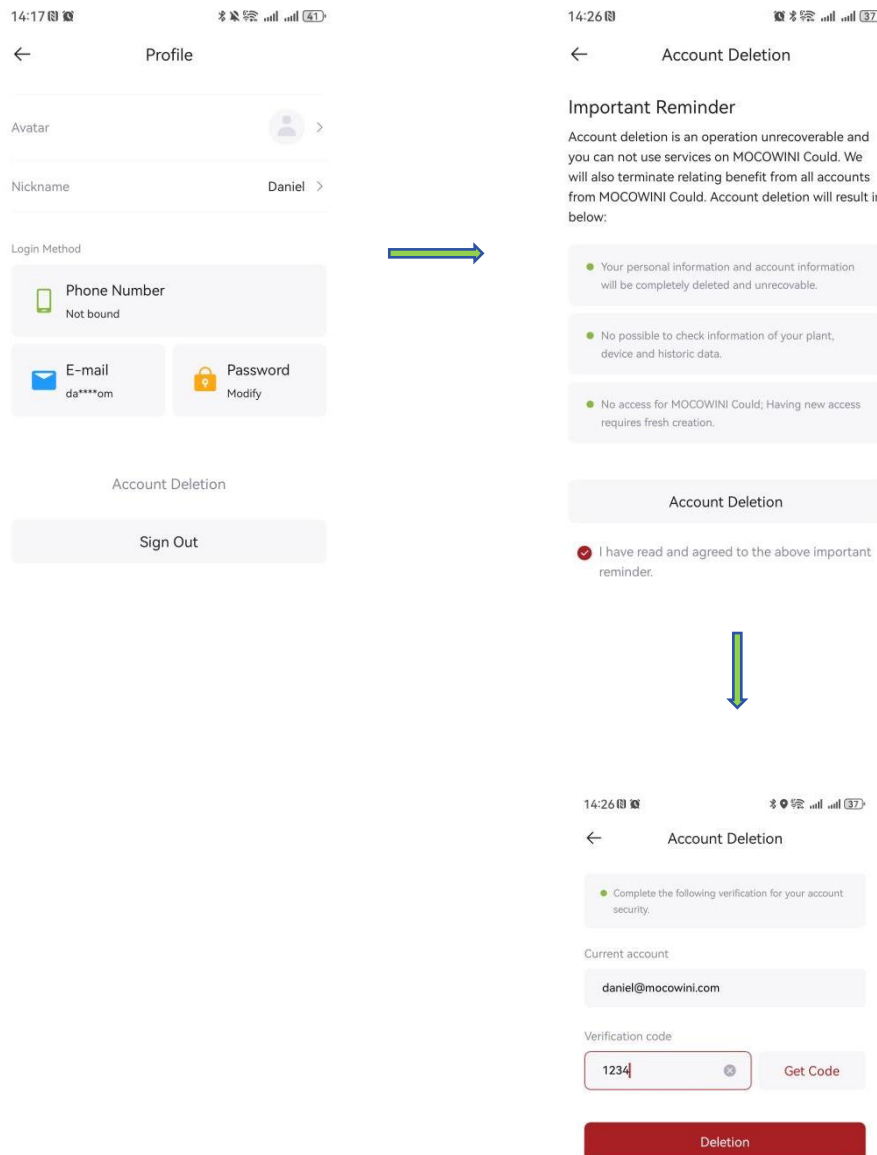

## 7 Create a plant

### 7.1 Enter

Click on "Plants" at the bottom left of the home page to go to the plant page, then click on the "+" at the top right, enter the "Add Device" interface, then click on the "Gateway" in the middle right of the screen, scan the QR code on the product label, and you can create the plant.

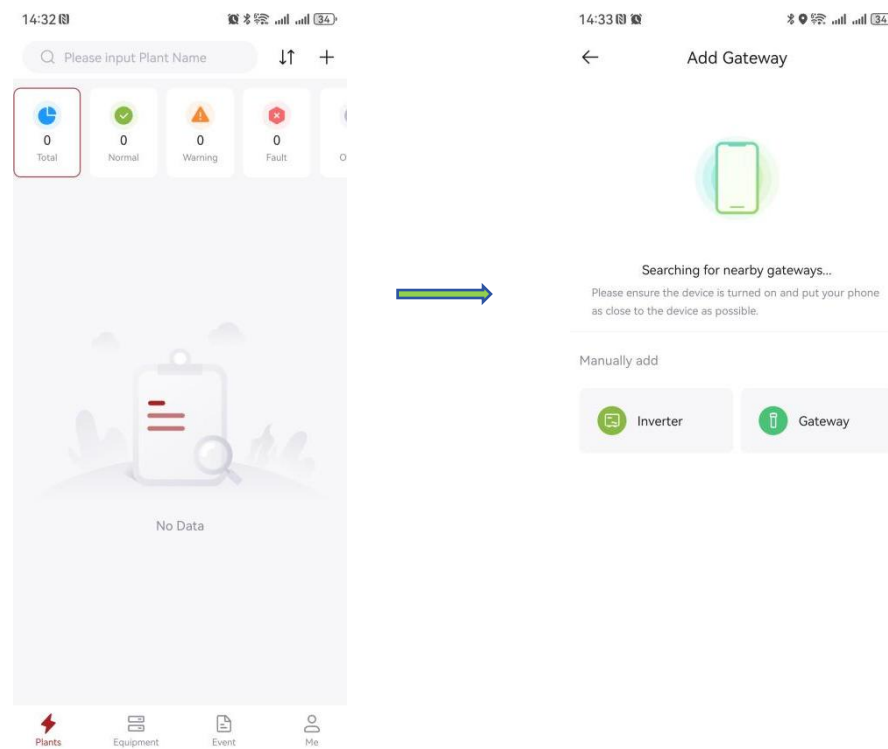

### 7.2 Bind Information

In the "Plant Information" interface, the content marked with "\*" is mandatory, others are optional. After filling in the information, click "Complete Creation". There will be a time zone prompt, please confirm according to the local situation. After completion, a "Network Configuration" interface will pop up, click "Creation Complete".

14:47

📶 31

← Plant Information

Profile

Plant Name \*

Please input Plant Name

Plant Photos

📷

Installed Capacity (kWp) \*

Please input the total capacity of the installed :

Operating Date \*

2025-03-26

>

Address \*

Please select the installation address

📍

Time Zone \*

(UTC+08:00)Beijing,Chongqing,Ho...

>

Installer

14:47

📶 31

← Plant Information

Address \*

Please select the installation address

📍

Time Zone \*

(UTC+08:00)Beijing,Chongqing,Ho...

>

Installer

Please Input...

Contacts

Manager \*

Please input Manager

Phone \*

Please input phone number

E-mail

Please input E-mail

Creation Complete

16:45

📶 98

👍

Congratulations, Created successfully

Distribution network

Done

## 7.3 Complete Creation

After completion, you can see your plant on the "Plants" page. Click on the plant and you can see the bound micro inverters on the "Equipment" page. After network configuration, you can see the data in the plant, details are in section 9 plant Monitoring.

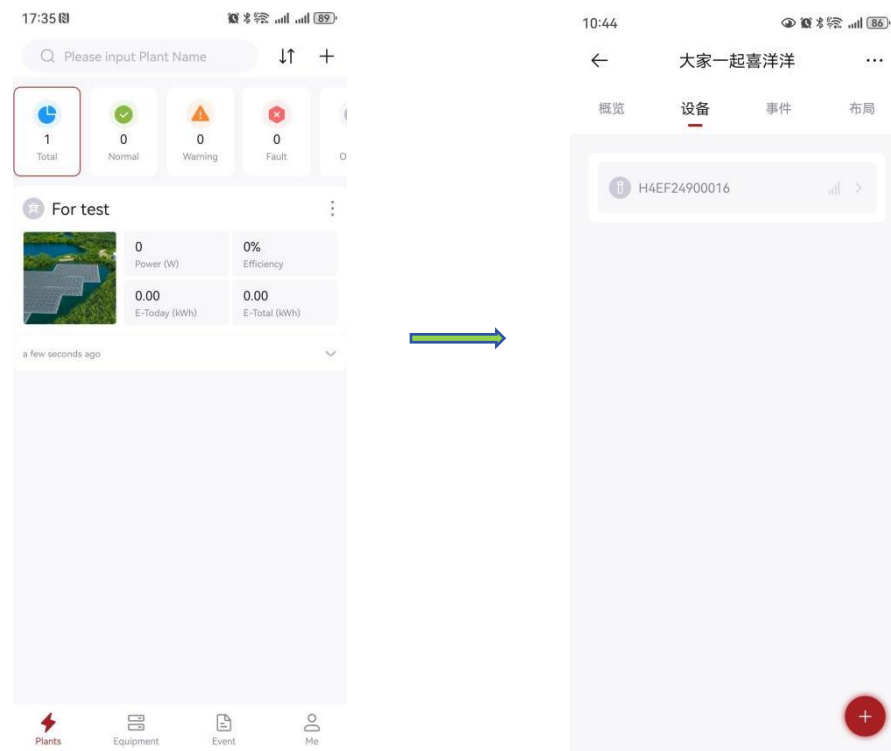

Note: When creating for the first time, the second and subsequent products do not need to be scanned again, just perform MESH network configuration, and select the already created power station after configuration.

## 8 Network Configuration

### 8.1 WiFi Configuration

Click on "Me" at the bottom right as shown in the figure:

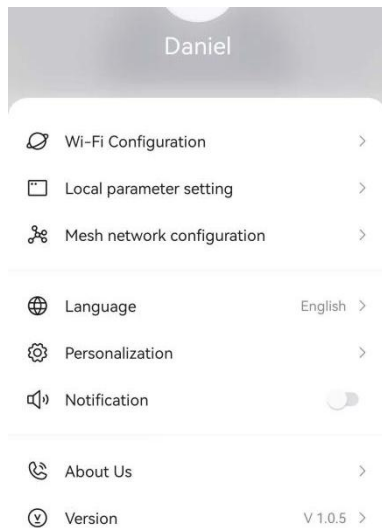

Figure 1 Mobile APP Personal Interface

1. Click on WiFi Network Configuration to enter the network configuration operation interface.



Figure 2 Configuration Prompt Interface

### 1.1 Configuration Prompt Operation

- ①The gateway is powered on and working properly.
- ②The router connected to the gateway is a 2.4G WiFi network.
- ③The gateway is within the Bluetooth coverage range of the phone.

1.2After confirming the above conditions, click Start Searching to enter the configuration interface.



Figure 3 WiFi Network Configuration Interface

2. The WiFi configuration interface is shown in Figure 3.

2.1 Scan the QR code provided by the machine, which includes the gateway SN and registration code.

2.2 Automatic search: View the body code, gateway code, and registration code, and complete the registration according to the instructions to register your plant.

## 8.2 MESH Configuration



Figure 4 MESH Network Configuration Interface

1. Follow the prompts to confirm::

- ①The phone's Bluetooth function is turned on.
- ②The inverter is powered on.
- ③Try to get close to the inverter and gateway.

④Configure the gateway network to 2.4G.

2. After confirming the above conditions, perform the configuration or remove the device.

2.1 Click Start Configuration to enter the device selection interface, and select the required device

according to the inverter nameplate or barcode as shown in Figure 5



Figure 5 Device selection Interface

2.2 Click Next to enter the network configuration.



Figure 6 Network Configuration Interface

2.3 For the first network configuration, select the default "Select Router for Network

Configuration"; the plant is the one registered by the gateway; select the 2.4G WiFi

network you use for WiFi, and enter the password for the corresponding WiFi network. Click

Confirm to start networking, showing "Configuring"; for the second configuration, you can choose

to network with the network configured by the plant, select the already networked WiFi name, and

you can skip entering the password and directly confirm the network configuration.

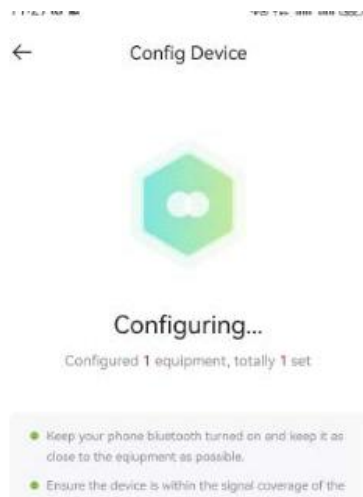

Figure 7 Configuring Devices Interface



Figure 8 Configuration Success Prompt Interface

2.4 After successful configuration, click Confirm.

2.5 After successful networking, you can choose to disable or enable the setting. Enabling means that unverified users will be required to enter a password for device networking, and clicking will take effect.

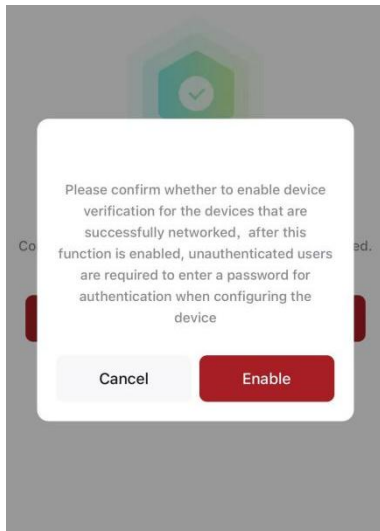

Figure 9 Optional Settings After Configuration Success

2.6 If a configuration failure prompt appears, troubleshoot and repeat the above operations based on the prompt.

Troubleshooting items one by one:

- ① The device is powered on.
- ② The phone is too far from the device.
- ③ The distance between devices is too far.
- ④ The 2.4G WiFi name and password do not match, or the password is entered incorrectly.

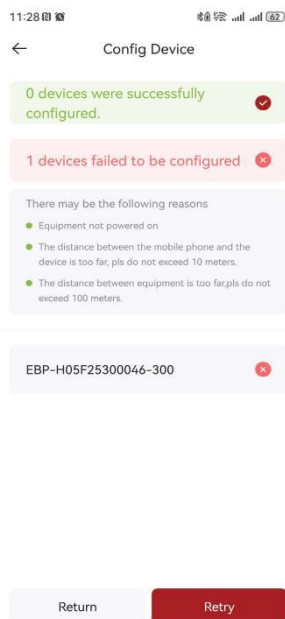

Figure 10 Operation Failure Prompt Interface

## 9 Plant Monitoring

### 9.1 Overview

After completing the network configuration, you can see the created plant in "Power Station". Clicking on the plant name or plant data can enter the details interface as shown in the figure:

#### 9.1.1 Total Power of Plant Station

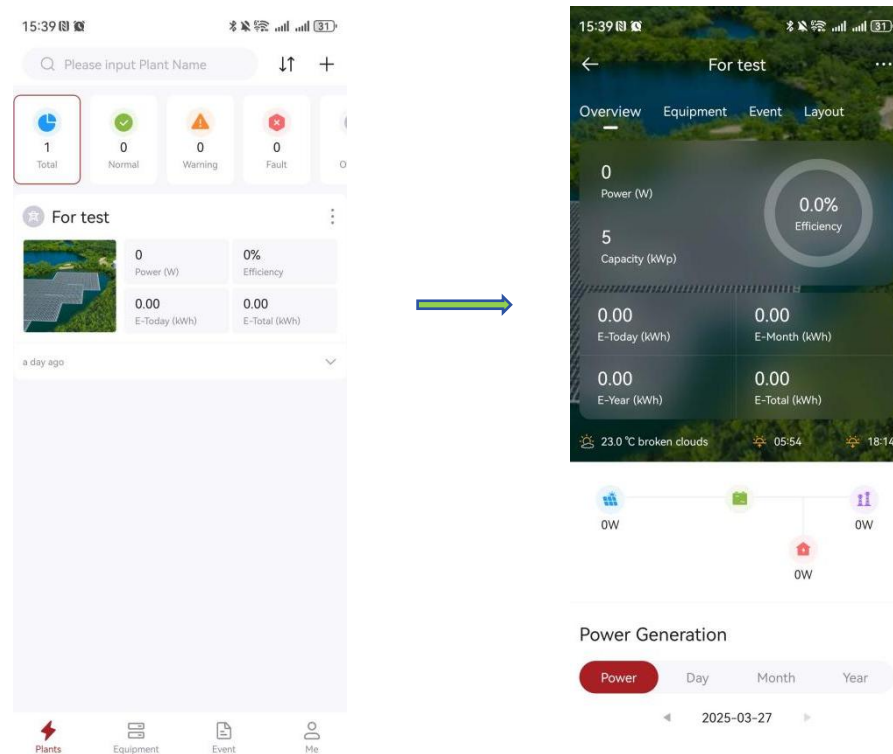

#### 9.1.2 Power Generation Data

Can be viewed by total power, day, month, year.

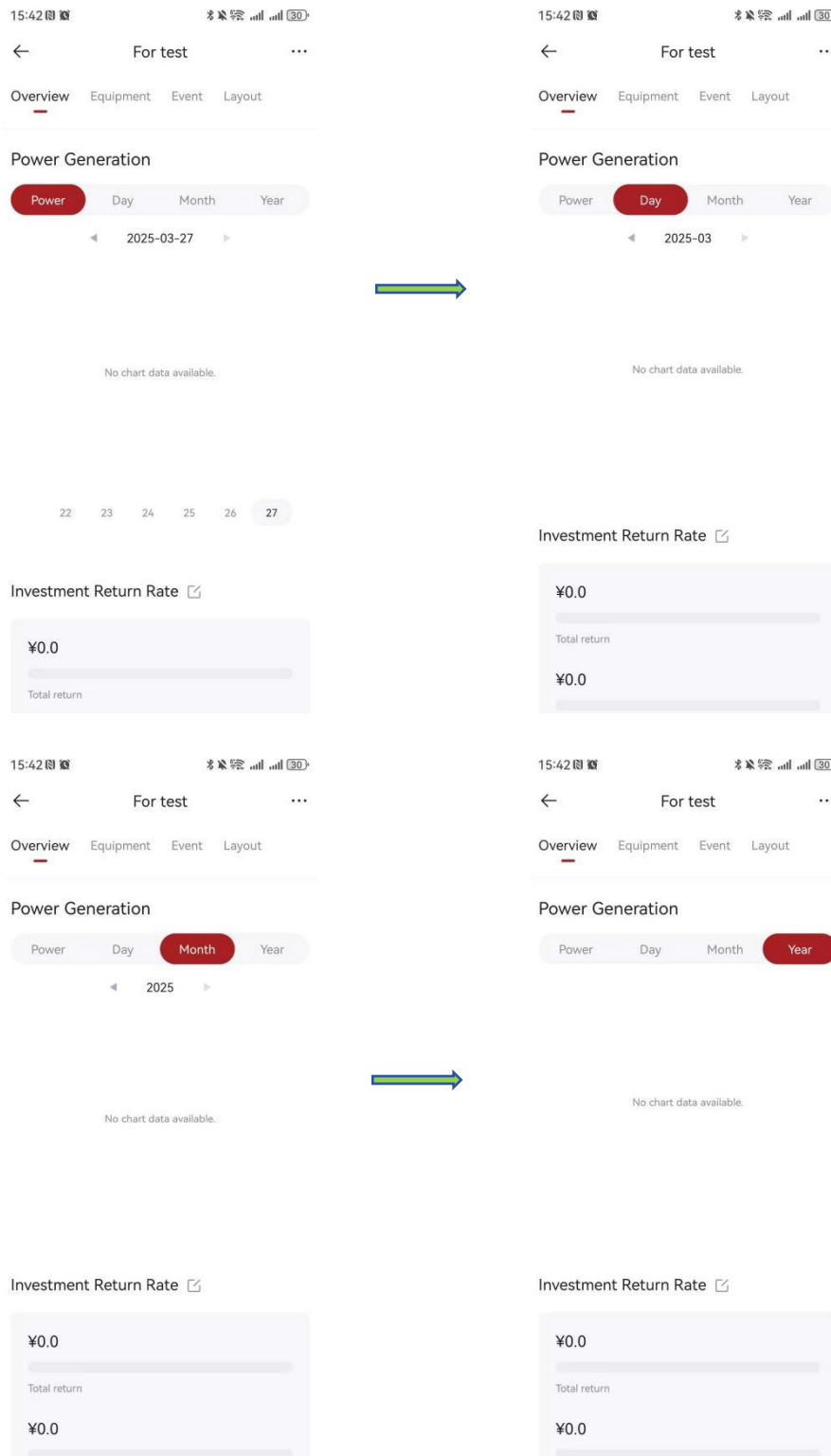

### 9.1.3 Investment Return & Energy-Saving Emission Reduction



You can set the currency unit and unit price in the investment return. Currently, the "unit price", "Currency", and "Valuation method" can only be modified by the dealer, and the user can modify

the "Cost of investment ". After modification, click "Save".

15:46 15:46 15:46

← For test ← For test ← For test

Overview Equipment Event Layout Overview Equipment Event Layout Overview Equipment Event Layout

Investment Return Rate  Investment Return Rate  Investment Return Rate 

¥0.0 ¥0.0 ¥0.0

Total return Total return Total return

¥0.0 ¥0.0 ¥0.0

Total investment Total investment Total investment

Energy Conservation Energy Conservation Energy Conservation

0.0 Kg CO<sub>2</sub> reduction 0.0 Kg SO<sub>2</sub> reduction 0.0 Kg CO<sub>2</sub> reduction 0.0 Kg SO<sub>2</sub> reduction 0.0 Kg CO<sub>2</sub> reduction 0.0 Kg SO<sub>2</sub> reduction

0 Trees Trees planted 0 Trees Trees planted 0 Trees Trees planted 0.0 Kg Standard coal reduction 0.0 Kg Standard coal reduction 0.0 Kg Standard coal reduction

— The end — — The end — — The end —

15:46 15:46 15:46

← Income Information Save ← Income Information Save ← Income Information Save

Currency Currency Currency

¥ ¥ ¥

Cost Of Investment Cost Of Investment Cost Of Investment

0 0 0

Valuation Method Valuation Method Valuation Method

Constant Price Constant Price Constant Price

Unit Price Unit Price Unit Price

1 1 1

When you have the authority of the dealer, you can modify it.

←

Income Information

Save

Currency

\$

>

Cost Of Investment

110

Valuation Method

Constant Price

>

Unit Price

2

After modification, click "Save" to activate.

### 9.1.4 More

Click on the plant to enter the plant details interface, click on the three dots at the top right to view more as shown in the figure:

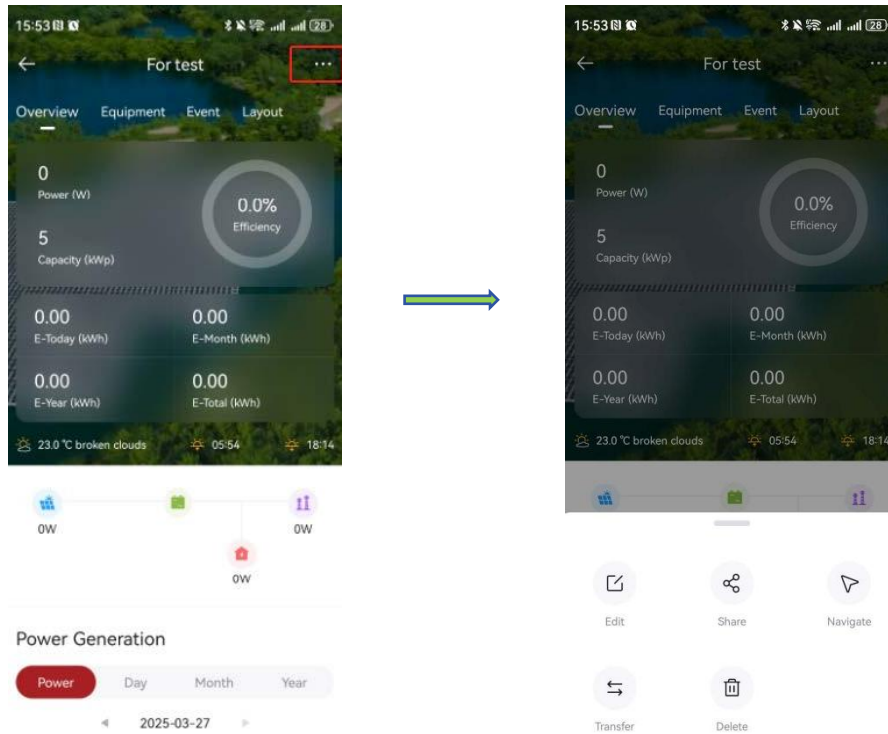

#### 9.1.4.1 Edit

Click "Edit" to modify the plant information. After modification, click "Save" at the top right to complete the modification.

#### 9.1.4.2 Share

Click "Share" to enter the account of the person to be shared and grant them permission.

#### 9.1.4.3 Navigate

Click "Navigate" to select a map tool. The destination is the installation address of the plant, and the starting point is the current location of the phone.

#### 9.1.4.4 Transfer

Click "Transfer" to enter the account of the transferee and transfer the plant to them.

#### 9.1.4.5 Delete

Click "Delete", then in the pop-up dialog box, enter "delete", click "OK" to complete the deletion.  
Please delete with caution.。

## 9.2 Equipment

### 9.2.1 Equipment Overview

In the "Equipment" section, you can see the status of micro inverters. Clicking on the "⋮" at the top right can view more information, as shown in the figure:

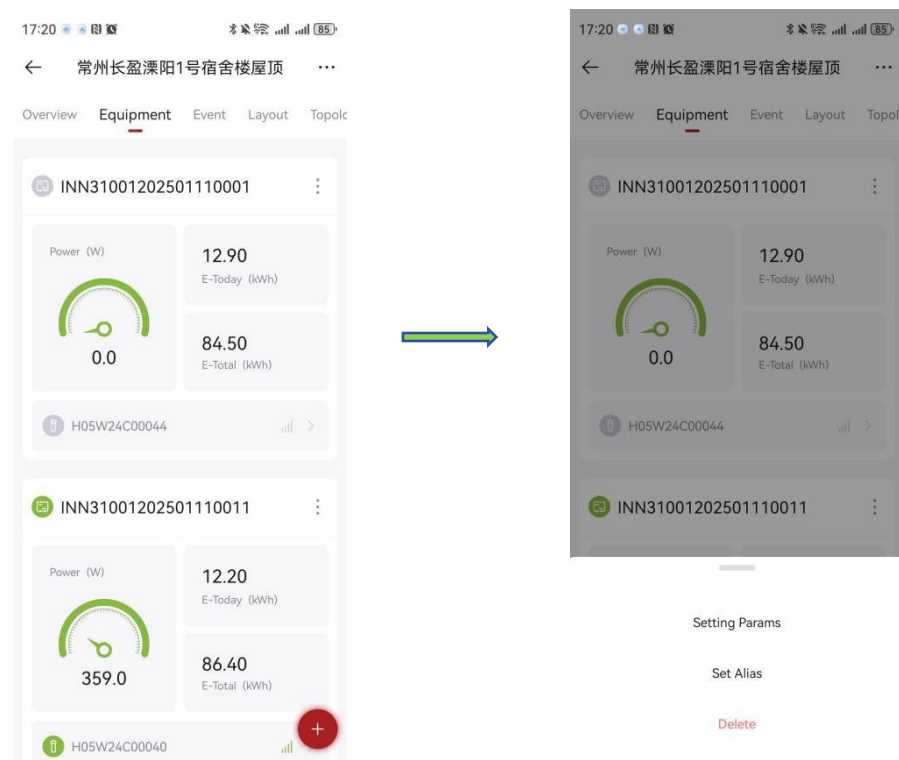

#### 9.2.1.1 Setting Params

Dealer privileges required.

Click "Parameter setting" to see different functions, as shown in the figure:



#### 9.2.1.1.1 System Parameters

You can set the "Menu Language". After setting, click "Save" to activate.

#### 9.2.1.1.2 Startup Parameters

You can set parameters such as grid connection time and rate. After modification, click "Save" to activate.

#### 9.2.1.1.3 Voltage Protection Parameters

You can set parameters such as AC overvoltage and undervoltage thresholds. After modification, click "Save" to activate.。

#### 9.2.1.1.4 Frequency Protection Parameters

You can set parameters such as AC frequency over and under frequency thresholds. After modification, click "Save" to activate.

#### 9.2.1.1.5 Restore Settings Function

You can perform a "Factory Reset" on the device to clear historical records, etc. After modification, click "Save" to activate.

#### 9.2.1.1.6 Switch On/Off Control

By default, "Switch On/Off Control" and "Automatic Startup on Power On" are enabled, and "Restart" function is disabled. After modification, click "Save" to activate.

#### 9.2.1.2 Equipment Alias

Can be set with Chinese, numbers, and English.

#### 9.2.1.3 Gateway Replacement

When there is a new gateway, you can use it by scanning the code or manually entering the "Serial Number" and "Registration Code".

#### 9.2.1.4 Delete

Only dealers can delete micro inverters. After deleting the micro inverter, you will no longer be able to see the product information, so please delete with caution.

### 9.2.2 Gateway

Clicking the ">" next to the gateway can enter the gateway page, where you can see status and other basic information, as shown in the figure:

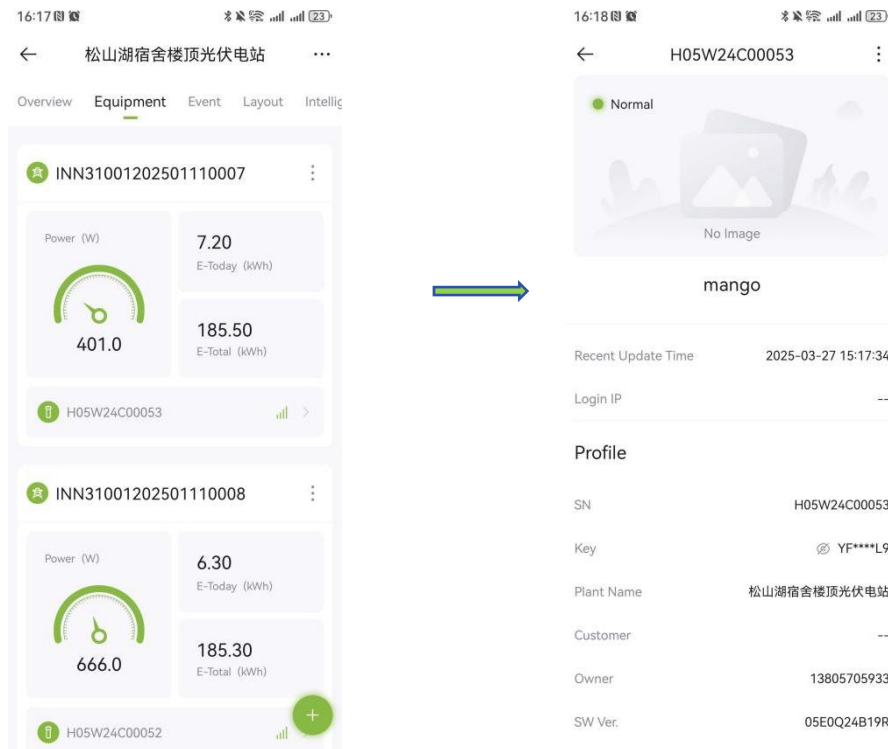

### 9.2.2.1 Unbind

After entering the gateway page, clicking the "..." at the top right shows that currently only dealers can perform the "Unbind" operation. After clicking Unbind, the micro inverter no longer belongs to the current plant and needs to be re-entered. Otherwise, you will not be able to see the product power and other information.。

## 9.2.3 Micro Inverter

### 9.2.3.1 Basic Information

In the equipment page, clicking on the title or "Power", "Today's Power Generation", "Cumulative Power Generation" can enter the micro inverter interface. Upon entry is the "Overview", where you can see the power generation, and swiping down can see the basic information of the micro inverter.

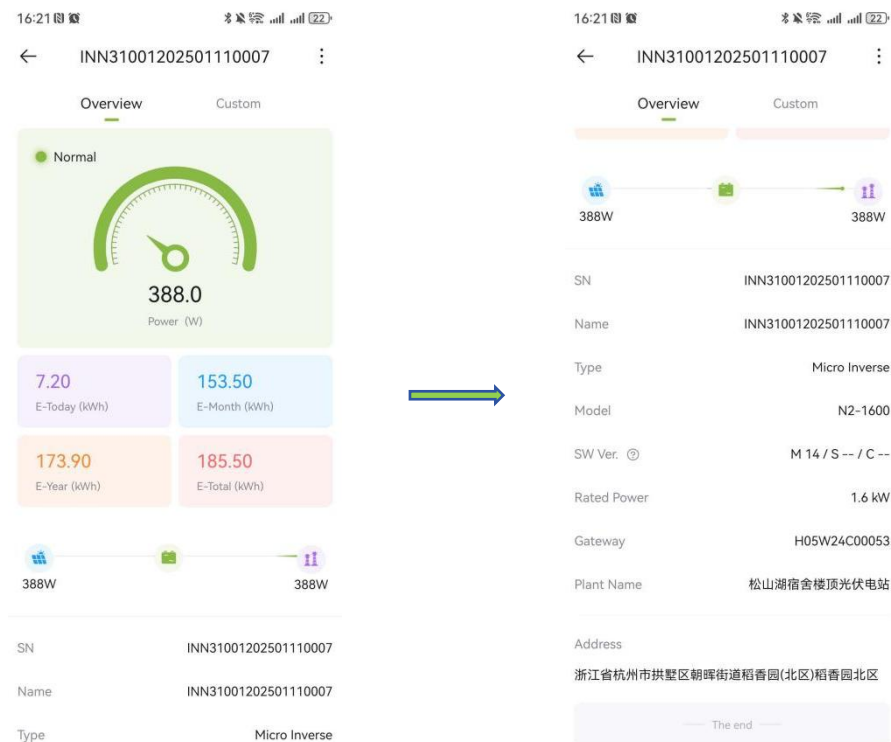

### 9.2.3.2 Customize

To the right of the "Overview" is "Custom", where you can see parameters such as "Inverter Voltage", which can be selected in the "Parameter Selection" below. Clicking once selects, clicking again deselects. Clicking the "Confirm" at the top right saves the changes.

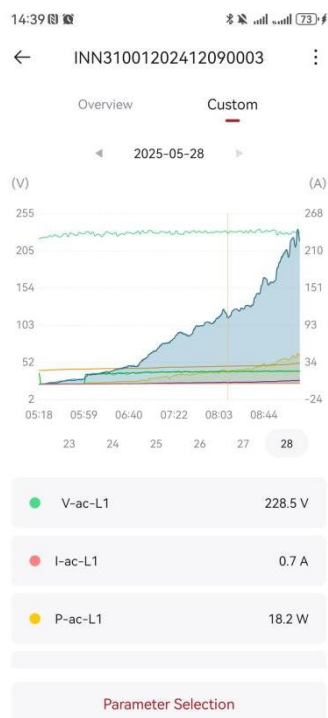
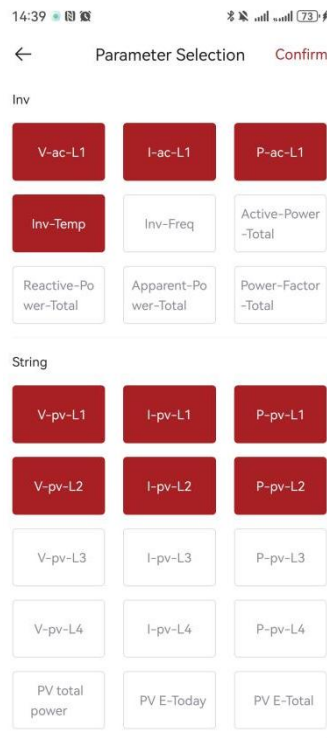

## 9.3 Events

You can see all historical information of the current plant. Historical fault, alarm, and other information of the product are displayed here, along with error codes, fault reasons, serial numbers, and occurrence times.

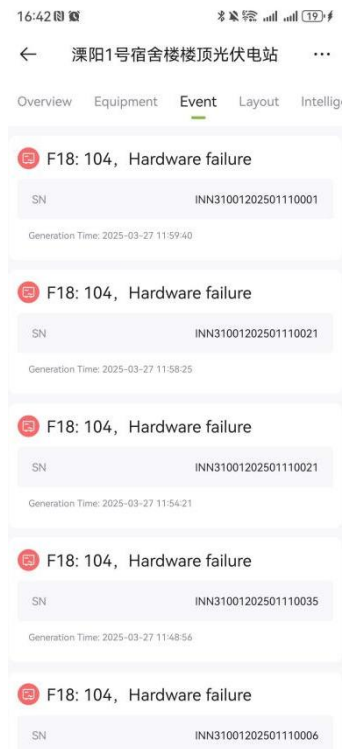

## 9.4 Layout

You can see the micro-inverse and the arrangement layout of the components. At the same time, you can choose either the logical layout or the physical layout, as shown in the figure:

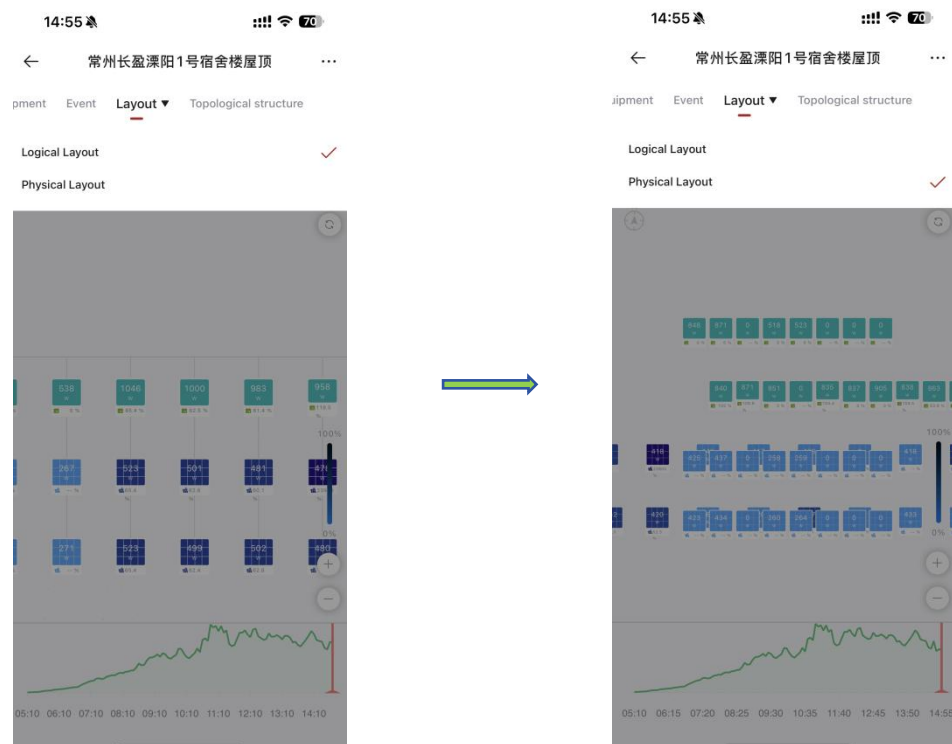

Click the "+" and "-" on the right to adjust the interface size, as shown in the figure.

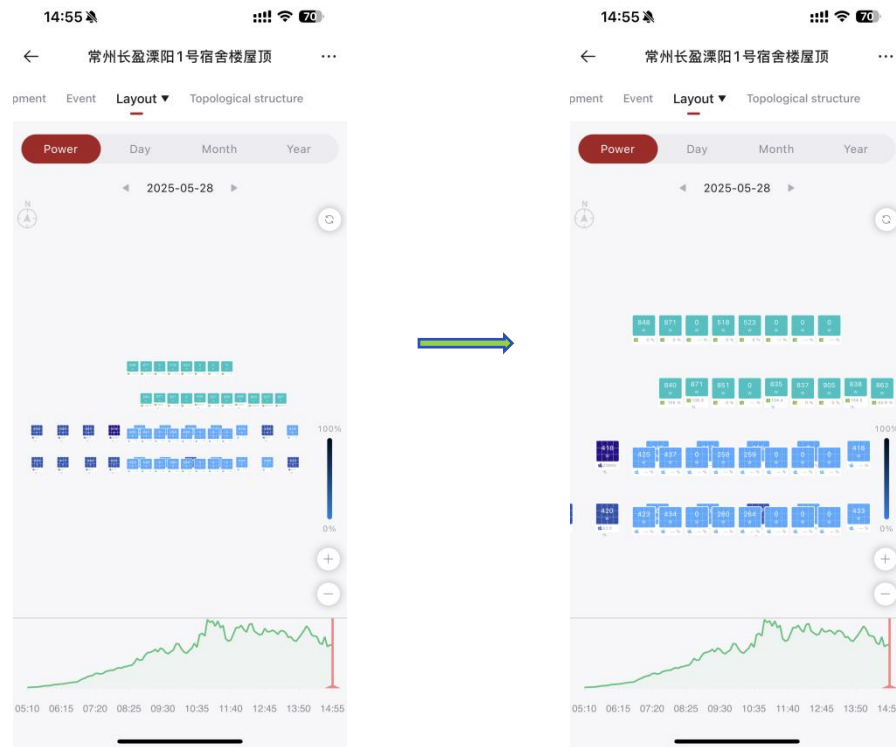

At the same time, you can also see the layout information related to the day, month and year, as shown in the figure:

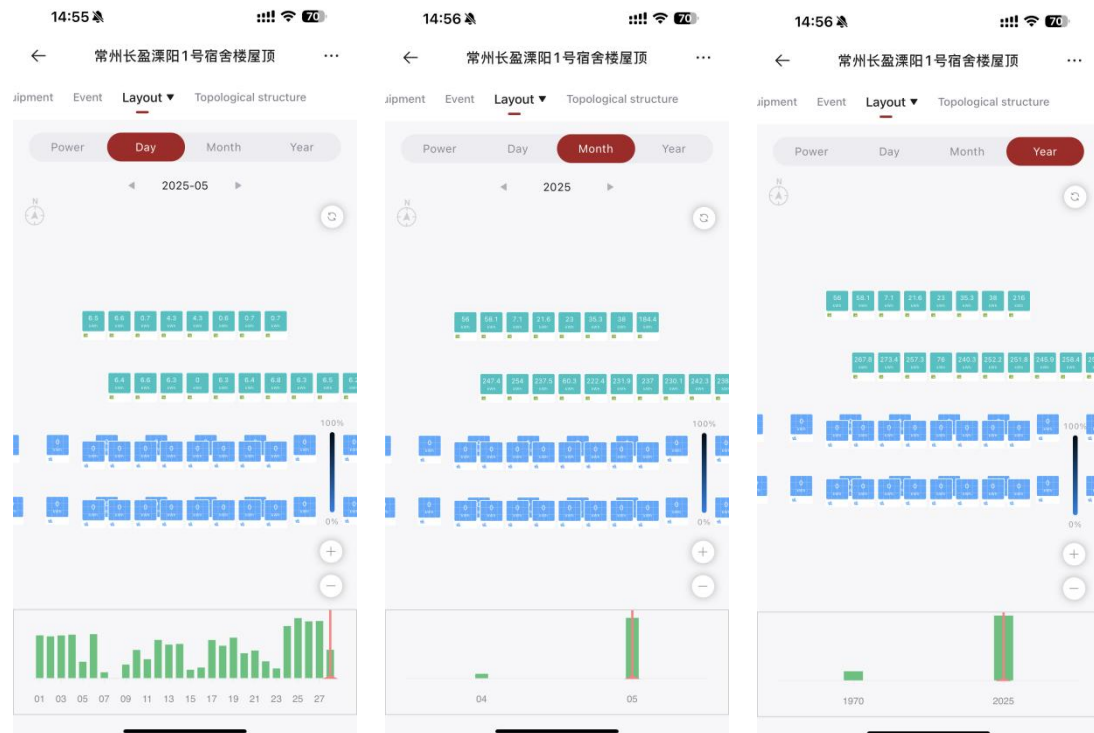

## 9.5 Topology

# 10 Equipment

## 10.1 Inverter Overview

In the "Equipment" section of the selection bar, the default entry shows the status of the "Inverter".The first bar is the status bar, where you can see if the inverter is Normal, offline, or in alarm, etc.

The middle and lower parts are the overviews of each micro inverter, with the inverter's "Name", "Power", "Today's Power Generation", and "Update Information". Clicking to enter has the same effect as 9.2.2 Micro Inverter.。

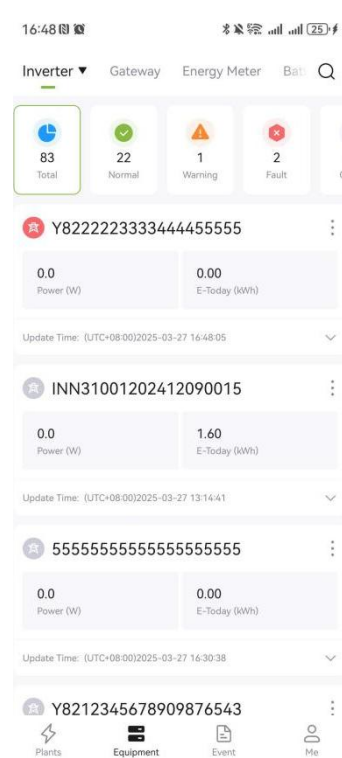

### 10.1.1 Inverter Type

You can select the inverter type via the dropdown arrow to the right of "Inverter" at the top, currently selecting "Micro Inverter", as shown in the figure::

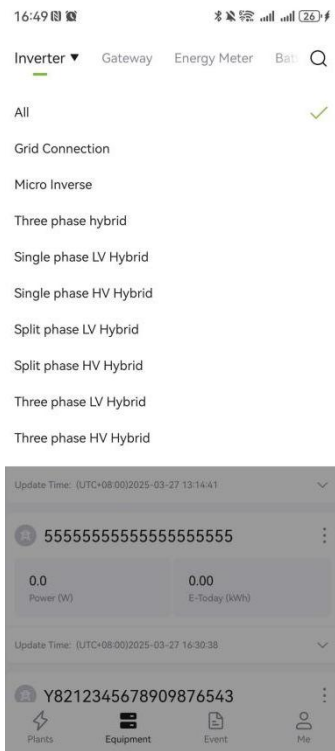

## 10.2 Gateway Overview

You can click "Gateway" at the top or swipe from the "Inverter" page to the "Gateway" page. On the gateway page, you can see the gateway's "Serial Number", "Device Name", "Signal Strength", and "Recent Update Time".

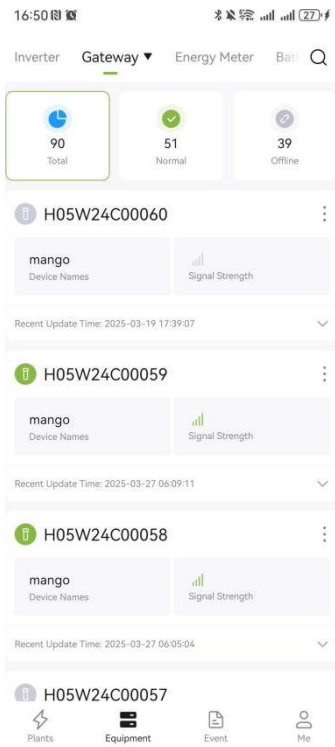

## 10.2.1 Gateway Type

The data Gateway type defaults to all.

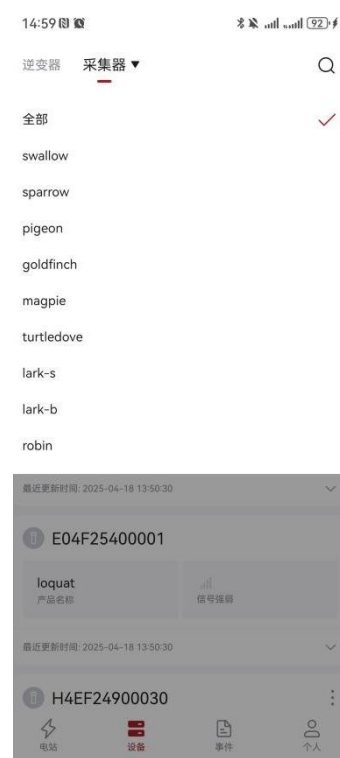

## 10.2.2 Gateway Details

Clicking on the data gateway has the same effect as 9.2.2 Gateway.

# 11 Events

## 11.1 Inveter

You can see all the problems that have occurred in the micro inverters of all plants, and you can select the type as "All", "Alarm", "Fault". Clicking the "Filter" icon at the top right can filter by "Today", "Last Three Days", "Last Seven Days".